

Clarke®

STRONG-ARM



CHAIN BLOCK

CCH2000C

PART NO: 7630473

OPERATION & MAINTENANCE INSTRUCTIONS

UK
CA | CE

ORIGINAL INSTRUCTIONS

GC12/24

INTRODUCTION

Thank you for purchasing this CLARKE Chain Block assembly.

Before attempting to use this product, please read this manual thoroughly and follow the instructions carefully. In doing so you will ensure the safety of yourself and that of others around you, and you can look forward to your purchase giving you long and satisfactory service.

INTENDED USE

The chain block assembly is a portable lifting device easily operated by the hand chain. It is suitable for use in factories, garages, farms, construction sites, docks and warehouses for installation of equipment, as well as for loading and unloading goods. It is specially advantageous for lifting work in open air grounds and places where no power supply is available.

The chain block can be attached to a trolley of any type as a travelling chain block. It is suitable for use with a monorail overhead conveying system, hand travelling crane and jib crane.

SPECIFICATIONS

	CCH2000C
Part Nos.	7630473
Capacity (tonnes)	2
Maximum Lift (mm)	3000
Min overall height (mm)	400
Max overall height (mm)	3200

GUARANTEE

This product is guaranteed against faulty manufacture for a period of 12 months from the date of purchase. Please keep your receipt which will be required as proof of purchase.

This guarantee is invalid if the product is found to have been abused or tampered with in any way, or not used for the purpose for which it was intended.

Faulty goods should be returned to their place of purchase, no product can be returned to us without prior permission. This guarantee does not effect your statutory rights.

SAFETY PRECAUTIONS

ALWAYS:

1. Inspect the general condition of the chain block and chains for signs of damage or wear before placing into storage.
2. Check that the load hook will reach its lowest point without running the chain fully out.
3. Ensure that the suspension point is strong enough to take the weight of the chain block and its load.
4. Check the travel path is clear and that you have a clear view to avoid any obstructions.
5. Wear industrial gloves when operating the chain block.
6. Wear a hard hat, safety shoes and safety goggles when operating the chain block.

NEVER:

1. Lift a load exceeding the rated capacity stated on the chain block.
2. Use the chain block when the chain is kinked.
3. Stand beneath a raised load.
4. Use the chain block if it requires more than ordinary effort to operate it.
5. Throw, drop or drag the chain block.
6. Use undue effort to force the block to operate.
7. Allow oil or grease to come into contact with the brake.
8. Lift loads at an angle or use for towing. Only lift loads vertically.
9. Never replace the load chain with a non-approved chain.

BEFORE LIFTING

1. Careful inspection should be made to the parts such as hook, load chain, braking device, etc. and the lubrication of the block. The chain block can only be put into operation when it is found to be in good condition.
2. Judge the weight of the load to be lifted and make sure the chain block is suitably rated. Never overload the block.
3. Attach the chain block to the suspension point.
 - The suspension point must be able to support the weight of the load and the chain block.
4. Attach the load hook directly to the load or sling, ensuring it is directly above the centre of gravity of the load.

OPERATION

1. Ensure that no obstruction prevents a clean lift
2. Gently raise or lower the load by pulling the hand chain through the block in the desired direction - Clockwise to lift and anti-clockwise to lower
 - While lifting or lowering a load, the hand chain should be pulled steadily to prevent it from jerking or tangling.
 - Lift the load a few centimeters and check stability before commencing full lift.
 - DO NOT allow anyone to walk or work under a lifting load.
 - When lowering a load, be aware that when the hand chain is released, the load will not stop immediately but may continue for a few more millimeters as the brake takes effect.

NOTE: The brake may get hot with continued use.

3. After operation, clean the chain block and lubricate the chain if required. Store it in a dry place to protect it from rust and corrosion.

JAMMING

Stop operation immediately if the hand chain cannot be pulled any further. Don't try to force the chain.

Proceed inspection as follows:

- a. If there is anything entangled with the load.
- b. Whether there is any trouble with the parts of the block.
- c. Whether the load weight is over the rated capacity of the block.

MAINTENANCE

EVERY SIX MONTHS

1. Fully unwind the lifting chain and check its general condition for corrosion, wear and signs of stretching or fracture.
2. Lubricate the chain and moving parts to inhibit corrosion.
3. Check the security and condition of the suspension point.
4. Check the condition of hooks and the tightness of all bolts and screws.

NOTE: When in constant use, the chain block should be inspected more frequently. If in doubt about the use or maintenance of this equipment, consult you local authorised CLARKE dealer.

COMPONENT PARTS

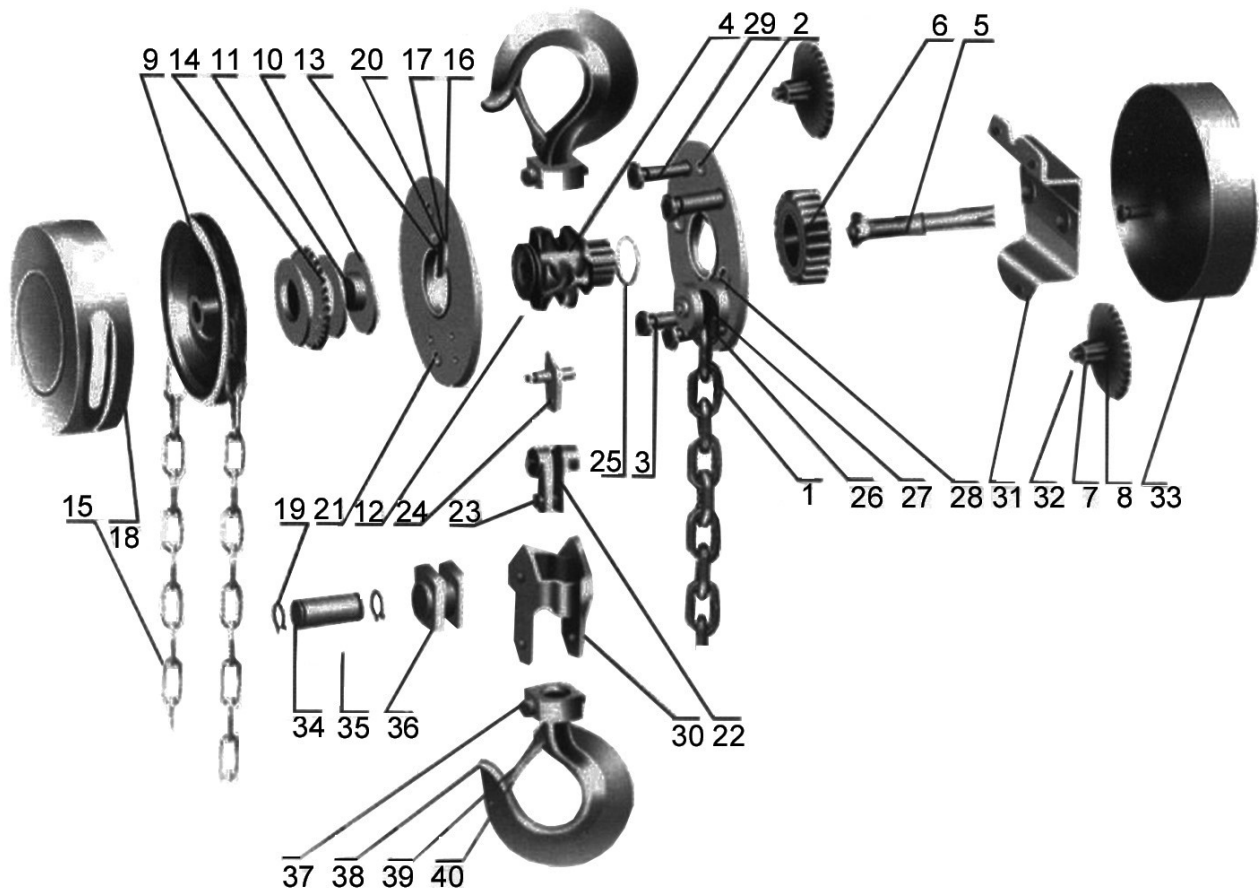

1. Load chain	11. Friction plate	21. LH Sideplate	31. Bent plate
2. RH Sideplate	12. Roller	22. Suspension plate	32. Roller
3. Stripper A	13. Bearing race	23. Suspension Pin	33. Sheet cover
4. Chain sprocket	14. Ratchet disc	24. Orifice plate	34. Idle sheave shaft
5. Driving shaft	15. Hand chain	25. Circlip	35. Headless rivet
6. Splined gear	16. Pawl spring	26. Left side plate	36. Idler sheave
7. Pinion shaft	17. Pawl	27. Guide roller	37. Hook holder
8. Disc Gear	18. Handwheel cover	28. Suspension pin	38. Pivot Pin
9. Handwheel	19. Circlip	29. Stay B	39. Latch
10. Brake seat	20. Pawl pin	30. Snap ring	40. Double spring

DECLARATION OF CONFORMITY - UK



Clarke[®]
INTERNATIONAL

Hemnal Street, Epping, Essex, CM16 4LG

DECLARATION OF CONFORMITY

This is an important document and should be retained.

We hereby declare that this product(s) complies with the following legislation:

The Supply of Machinery (Safety) Regulations 2008

The following standards have been applied to the product(s):

EN 13157:2004+A1

The technical documentation required to demonstrate that the product(s) meet(s) the requirement(s) of the aforementioned legislation has been compiled and is available for inspection by the relevant enforcement authorities.

The UKCA mark was first applied in: 2024

Product Description:	Chain Block
Model Number(s):	CCH2000C
Serial/Batch Number:	Refer to product/packaging label
Date of Issue:	23/12/2024

Signed:

J.A Clarke

Director

DECLARATION OF CONFORMITY - CE



Clarke[®]
INTERNATIONAL

Fitzwilliam Hall, Fitzwilliam Place, Dublin 2

DECLARATION OF CONFORMITY

This is an important document and should be retained.

We hereby declare that this product(s) complies with the following legislation:

2006/42/EC *Machinery Directive*

The following standards have been applied to the product(s):

EN 13157:2004+A1

The technical documentation required to demonstrate that the product(s) meet(s) the requirement(s) of the aforementioned legislation has been compiled and is available for inspection by the relevant enforcement authorities.

The CE mark was first applied in: 2024

Product Description:	Chain Block
Model Number(s):	CCH2000C
Serial/Batch Number:	Refer to product/packaging label
Date of Issue:	23/12/2024

Signed:

J.A Clarke

Director

A SELECTION FROM THE VAST RANGE OF

Clarke®

QUALITY PRODUCTS



AIR COMPRESSORS
From DIY to industrial, Plus air tools, spray guns and accessories.

GENERATORS
Prime duty or emergency standby for business, home and leisure.

POWER WASHERS
Hot and cold, electric and engine driven - we have what you need

WELDERS
Mig, Arc, Tig and Spot. From DIY to auto/industrial.

METALWORKING
Drills, grinders and saws for DIY and professional use.

WOODWORKING
Saws, sanders, lathes, mortisers and dust extraction.

HYDRAULICS
Cranes, body repair kits, transmission jacks for all types of workshop use.

WATER PUMPS
Submersible, electric and engine driven for DIY, agriculture and industry.

POWERTOOLS
Angle grinders, cordless drill sets, saws and sanders.

STARTERS/CHARGERS
All sizes for car and commercial use.



PARTS & SERVICE: 0208 988 7400

Parts Enquiries
Parts@clarkeinternational.com

Servicing & Technical Enquiries
Service@clarkeinternational.com

SALES: UK 01992 565333 or Export 00 44 (0)1992 565335

Clarke INTERNATIONAL Hemnall Street, Epping, Essex CM16 4LG
www.clarkeinternational.com